

Amorphous silicon solar panel

Quote date: 2012-06-16



Electrical Specification

Modle	103Wp	100Wp	97Wp	94Wp	91Wp
Power Output(Wp)	103W	100W	97W	94W	91W
Voltage at Pmax(Vmp)	77.0V	76.0V	75.5V	75.0V	73.5V
Current at Pmax(Imp)	1.34A	1.32A	1.29A	1.26A	1.24A
Open-circuit Voltage(Voc)	101.0V	100.0V	99.0V	98.0V	97.0V
Short-circuit Current(Isc)	1.66A	1.64A	1.61A	1.57A	1.55A

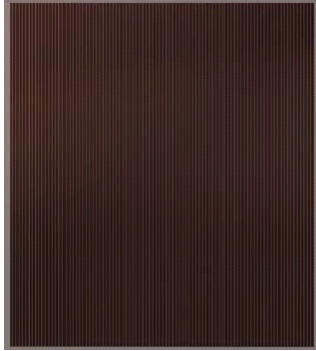

I-V Curves

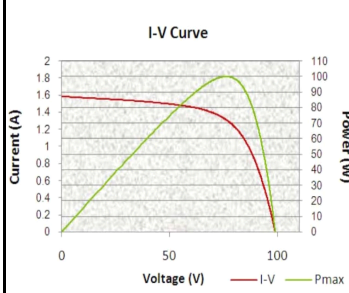

Key Features

Dimensions	1400*1100*7mm
Weight	25.5kg
Technology	Amorphous silicon
Front Cover	3.2mm TCO float glass
Material for Encapsulation	Polyvinylbutyral (PVB)
Back Cover	3.2mm heat strengthened glass
Junction box	MC4 compatible with IP67
Junction Box Bypass Diode	1000V/5A

Temperature and Coefficients

Maximum Power (W):	-0.24 (%/°C)
Open Circuit Voltage (V):	-0.42 (%/°C)
Short Circuit Current (A):	+0.06 (%/°C)

Operational Limits

Max System Voltage:	1000 Vdc
Operation Temperature:	-40 °C to +85 °C

All electric data is stabilized performance at standard test conditions(STC) and is subject to a measuring equipment tolerance of + 5%. (STC: 1000W/m², AM 1.5, 25°C)

Panel Drawing Map

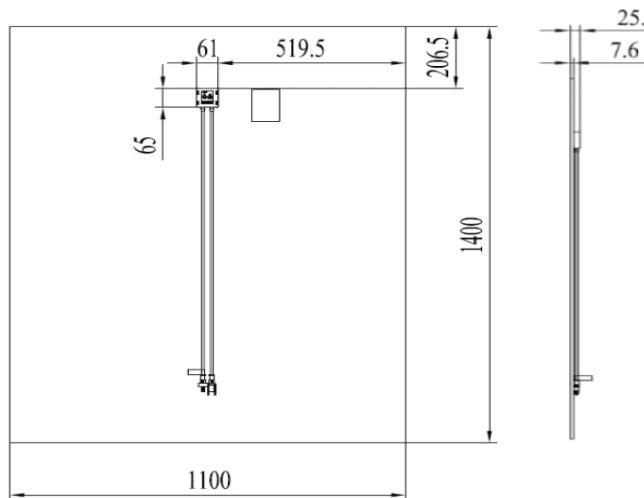

Warranties

Product Warranty	5 Years
90% of the minimal Nominal Power Output	10 Years
80% of the minimal Nominal Power Output	25 Years